

T90-3,5

AMT9035C



Ratio
Rapporto
1:1



RPM
Velocità
4.000 min⁻¹



Max. axial load
Max. carico assiale
1.250 N



Torque
Momento torcente
50 Nm



Weight
Peso
11 kg



Collet
Pinza
ER-32 (ø 2/20 mm)

* STANDARD EQUIPMENT INCLUDES:

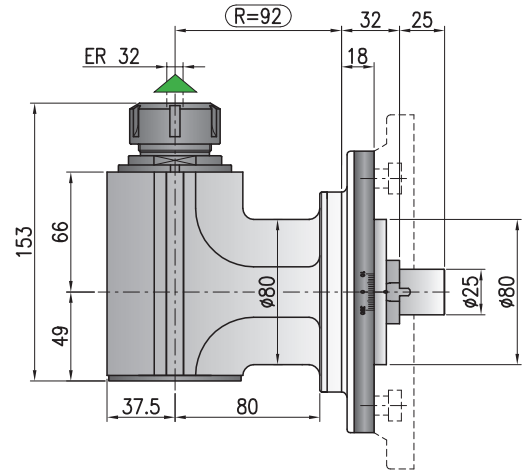
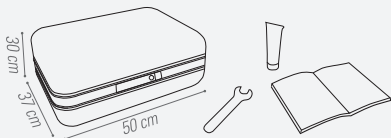

Minimum diameter without tool
Diametro minimo senza utensile

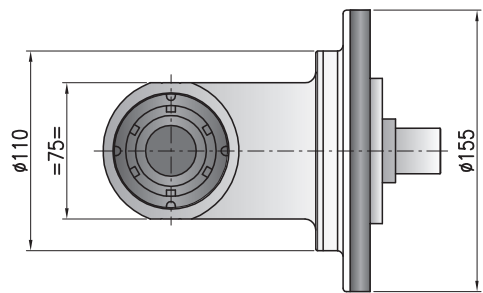
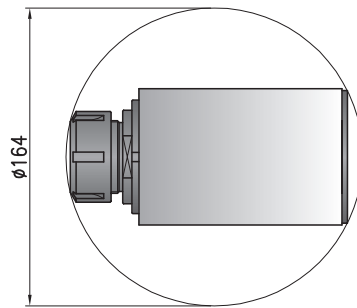

▲ Direction of rotation same as machine spindle / senso di rotazione uguale al mandrino

Shank/Cono	DIN-69871	CAT	MAS-BT	HSK	CAPTO	KM

Option / Opzione



bar max
12

Coolant through spindle
Adduzione refrigerante interna



min⁻¹
6.000

High speed optional RPM max.
Opzione alta velocità RPM max.



Ø mm
27

Arbor output
Porta fresa



Ø mm max.
20

Weldon output
Weldon



ISO-30 HSK-40

Quick Change
Attacco rapido



ER-32/ER-20

Double output
Doppia uscita

T90-3,5L

AMT9035L

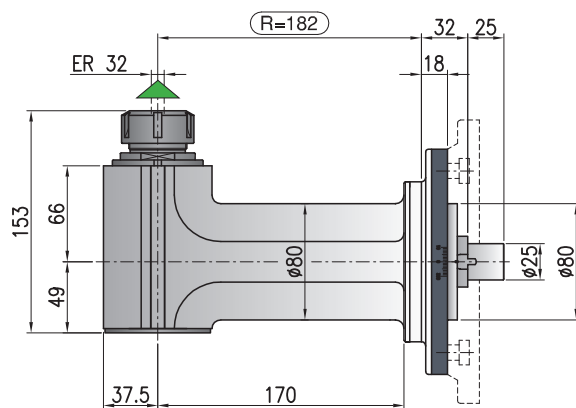

Minimum diameter without tool
Diametro minimo senza utensile

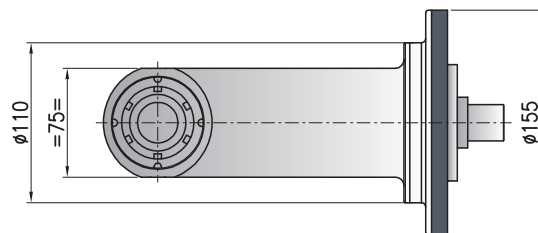
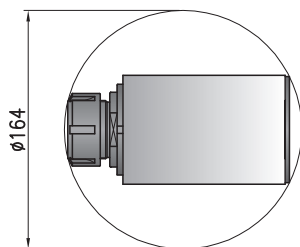

Ratio
Rapporto
1:1



RPM
Velocità
4.000 min⁻¹



Max. axial load
Max. carico assiale
1.250 N



Torque
Momento torcente
50 Nm



Weight
Peso
13,2 kg



Collet
Pinza
ER-32 (Ø 2/20 mm)

*** STANDARD EQUIPMENT INCLUDES:**

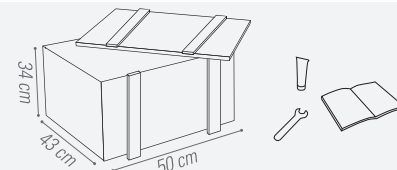

Direction of rotation same as machine spindle / senso di rotazione uguale al mandrino

Shank/Cono	DIN-69871	CAT	MAS-BT	HSK	CAPTO	KM

Option / Opzione



bar max
12

Coolant through spindle
Adduzione refrigerante interna



min⁻¹
6.000

High speed optional RPM max.
Opzione alta velocità RPM max.



Ø mm
27

Arbor output
Porta fresa



Ø mm max.
20

Weldon output
Weldon



ISO-30 HSK-40

Quick Change
Attacco rapido



ER-32/ER-20

Double output
Doppia uscita